

GR

EN

DE

ES

PL

PT

FR

HU

IT

NL

SE

RU



KIT SOVRAPPOSIZIONE LAVATRICE - ASCIUGATRICE

WASHING MACHINE - DRYER **STACKING KIT**

55402094

MADE IN EU

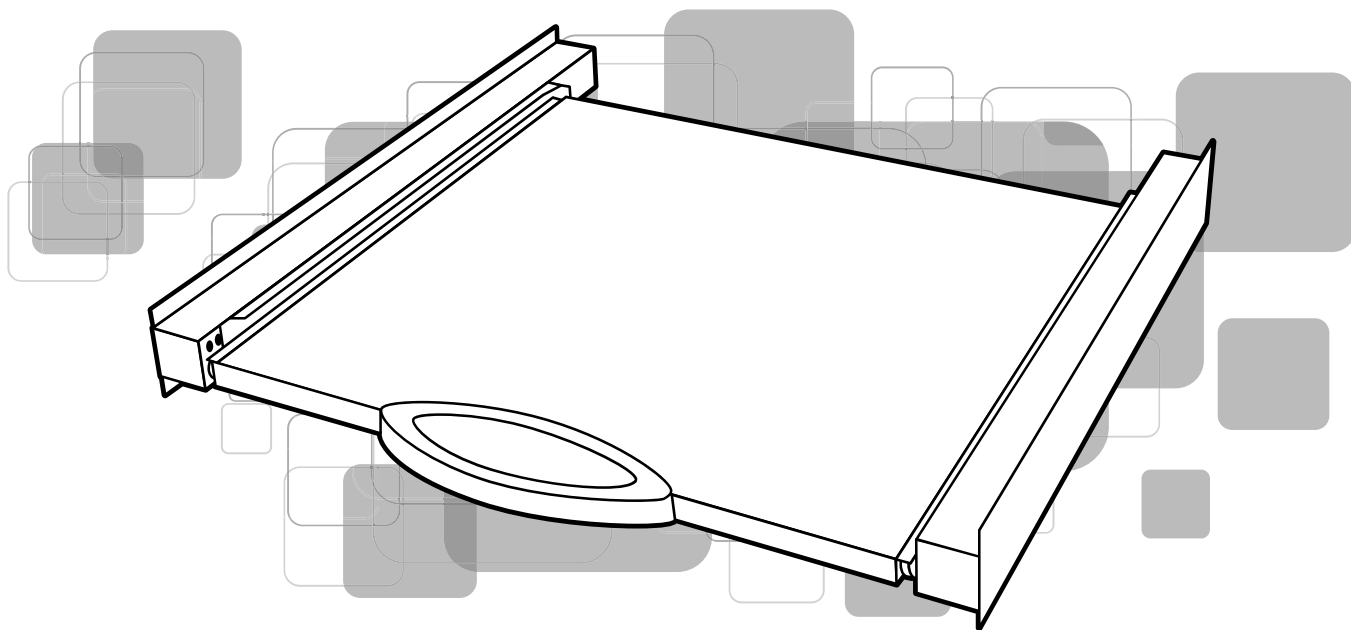

RICAMBI PER ELETTRODOMESTICI
SPARE PARTS FOR HOUSEHOLD APPLIANCES

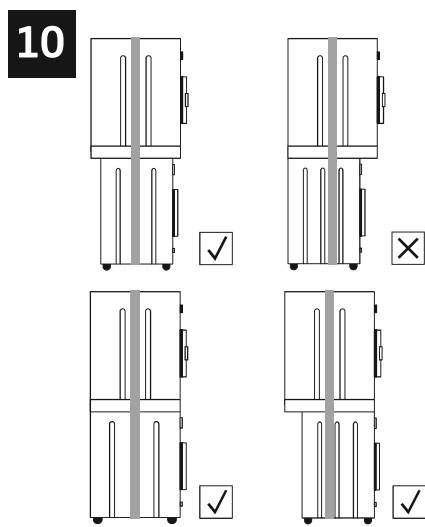
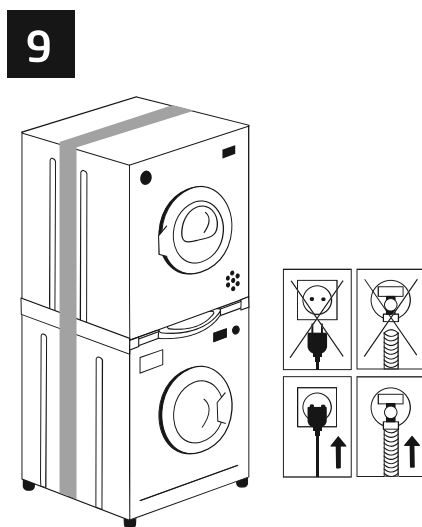
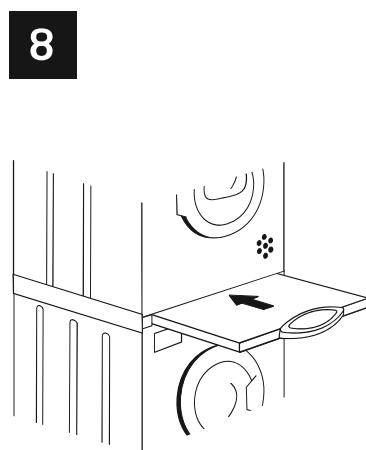
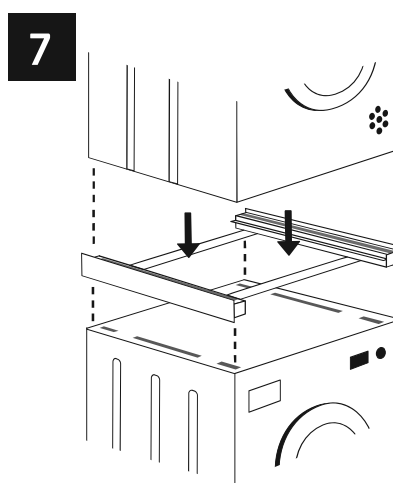
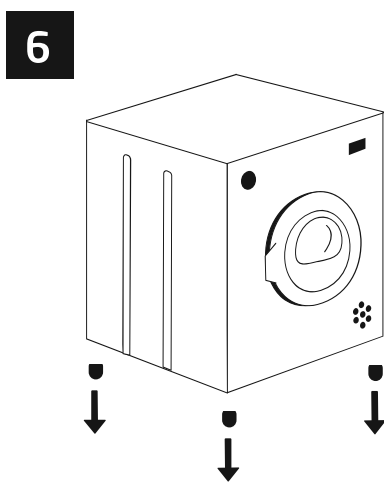
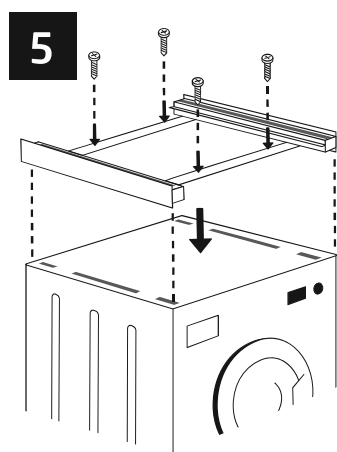
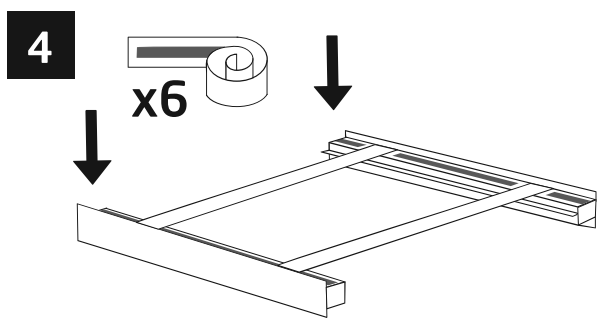
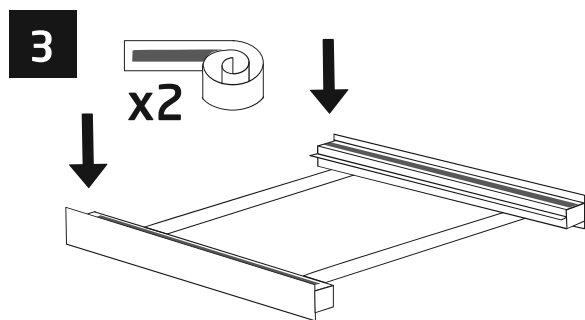
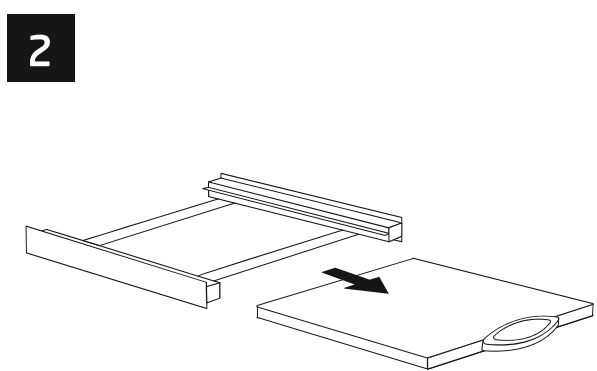
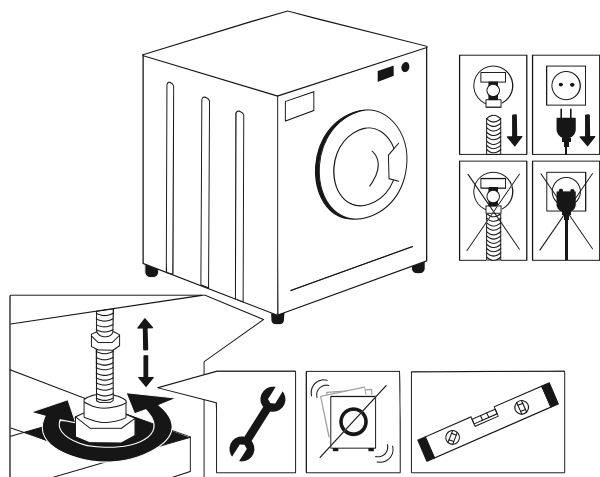



D

B

A

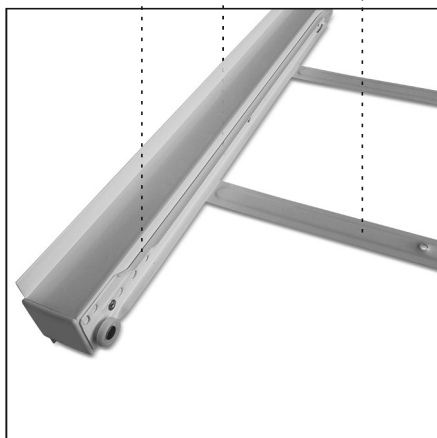



C

F

G

E

Read the following instructions and information. Keep these operating instructions in a safe place for future reference. This Stacking kit is intended only for mounting a household dryer on a household washing machine.

The ASTELAV S.r.l assumes no liability for damage to the product, for property damage or for personal injury due to careless or improper installation, or usage of the product, or usage of product which does not meet the manufacturer's specified purpose.

Safety notes

- The product is intended for private, non-commercial use only.
- The product is intended for indoor use only.
- Use the product for its intended purpose only.
- The manufacturer waives any responsibility arisen from incorrect usage, transportation or wrong installation.
- Children must not play with the product.
- Cleaning, maintenance and installation works should not be performed by children.
- Make sure that no load should exceed the maximum permitted carrying capacity.
- Make sure that the product is loaded symmetrically.
- In the event of damage to the product, remove the attached load and stop using the product.
- Please observe while you install the product, that no cable or hose will be damaged.

Instructions

Note

The installation must be carried out by at least 2 people.

1. Ensure that your washing machine and dryer are disconnected from the mains power and the water supply before installation.
Make sure that the washing machine is steady. If needed adjust the height of your washing machine's feet to position the device optimally. Use a spirit level to ensure that the mounted devices are exactly level.
2. Remove the shelf (a) from the product.
- 3-4. Place the foam strips (e) on both sides of the stacking kit as shown in the pictures.
5. Then place the stacking kit on top of the washing machine (the metal connection rails (b) should be under the aluminum profile (c)).

Note: For extra safety, is recommended the stacking kit to be screwed on to the washing machine cover using the 4 screws (g) included in the kit. Ensure that the screws do not damage any of the underlying washing machine components

6. Remove the feet from the dryer.
7. Lift the dryer and place it on top of the product.

Note: Graphics on picture 10 will assist you to place the stacking kit and the dryer correctly on the washing machine.

Ensure that you placed the devices the one on top of the other properly.

8. Put the shelf back on the drawer slides (d).
9. Bind the mounted devices side to side by using the lashing strap (f) and pull it tight to prevent the structure from moving or falling over. Perform periodic checks on the position of dryer and stacking kit and the stability of lashing strap.

Note: If the strap gets damaged over the time, it has to be replaced immediately.

Connect your devices to the mains power and the water supply. Your devices are ready for use.

Note

The shelf has a maximum carrying load of up to 20 kgs. The lashing strap can be used only for the purposed described. Do not tie knots in the lashing strap and do not lash it across sharp edges. Avoid hot areas >90 C. Check the lashing strap and its tension at regular intervals. Do not use the strap or the lock if they are damaged. Maximum lashing capacity 125 daN. Don't put the washing machine on top of the dryer. For the installation of the product are needed minimum 2 persons.

Product Information

Width (product): 55 cm
Length (product): 60 cm
Maximum weight load (product): 150 kgs
Width (shelf): 48 cm
Length (shelf): 50 cm
Maximum weight load (shelf): 20 kgs

A	Shelf
B	Metal connection rails
C	Aluminum profile
D	Drawer slide
E	Foam strip
F	Lashing strap
G	Screws